





REFUSE COLLECTION STRATEGY:

-  Denotes Refuse Vehicle Swept Path.
-  Refuse Vehicle Wheel Path.
-  Refuse Vehicle Chassis Path.
-  Denotes Bin Collection Point.
-  Denotes Individual Bin Collection Point.

- NOTES**
1. Contractors must check all dimensions on site. Only figured dimensions are to be worked from. Discrepancies must be reported to the Architect or Engineer before proceeding. © This drawing is copyright.
 2. Reproduced from OS Sitemap © by permission of Ordnance Survey on behalf of The Controller of Her Majesty's Stationery Office. © Crown copyright 2008. All rights reserved. Licence number 100007126.
 3. Direct scaling off the drawing is permissible for planning purposes only.

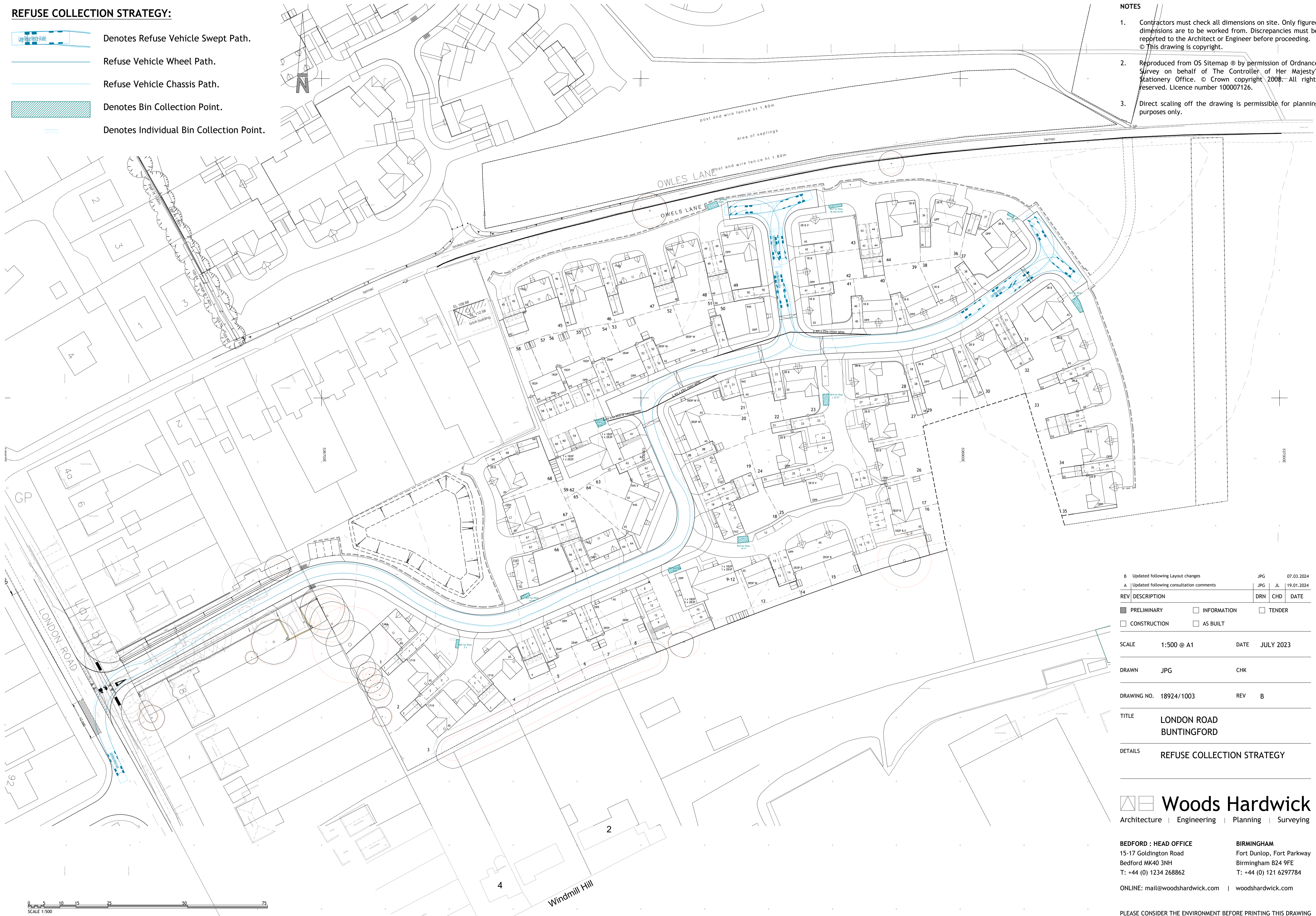

B	Updated following Layout changes	JPG	JL	07.03.2024
A	Updated following consultation comments	JPG	JL	19.01.2024
REV	DESCRIPTION	DRN	CHD	DATE
<input checked="" type="checkbox"/>	PRELIMINARY	<input type="checkbox"/>	<input type="checkbox"/>	<input type="checkbox"/>
<input type="checkbox"/>	CONSTRUCTION	<input type="checkbox"/>	<input type="checkbox"/>	<input type="checkbox"/>
<input type="checkbox"/>	INFORMATION	<input type="checkbox"/>	<input type="checkbox"/>	<input type="checkbox"/>
<input type="checkbox"/>	AS BUILT	<input type="checkbox"/>	<input type="checkbox"/>	<input type="checkbox"/>

SCALE 1:500 @ A1 DATE JULY 2023

DRAWN JPG CHK

DRAWING NO. 18924/1003 REV B

TITLE LONDON ROAD
BUNTINGFORD

DETAILS REFUSE COLLECTION STRATEGY

 **Woods Hardwick**
Architecture | Engineering | Planning | Surveying

BEDFORD : HEAD OFFICE
15-17 Goldington Road
Bedford MK40 3NH
T: +44 (0) 1234 268862

BIRMINGHAM
Fort Dunlop, Fort Parkway
Birmingham B24 9FE
T: +44 (0) 121 6297784

ONLINE: mail@woodshardwick.com | woodshardwick.com

PLEASE CONSIDER THE ENVIRONMENT BEFORE PRINTING THIS DRAWING

