

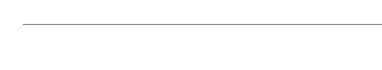

Tracking:

-  Denotes Fire Appliance Swept Path.
-  Fire Appliance Wheel Path.
-  Fire Appliance Chassis Path.
-  Fire Appliance Hose.

NOTES

1. Contractors must check all dimensions on site. Only figured dimensions are to be worked from. Discrepancies must be reported to the Architect or Engineer before proceeding. © This drawing is copyright.
2. Reproduced from OS Sitemap © by permission of Ordnance Survey on behalf of The Controller of Her Majesty's Stationery Office. © Crown copyright 2008. All rights reserved. Licence number 100007126.
3. Direct scaling off the drawing is permissible for planning purposes only.

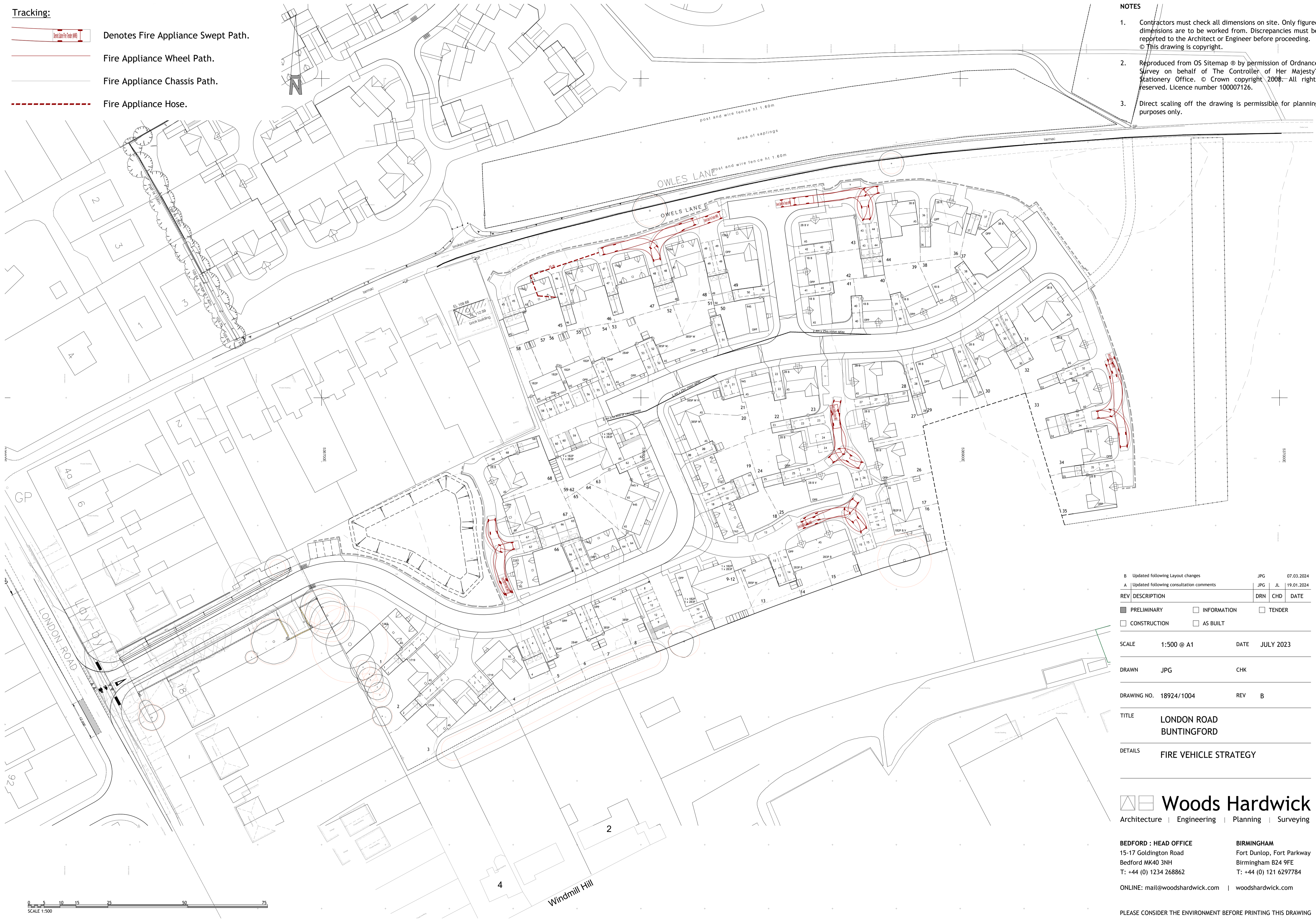

B	Updated following Layout changes	JPG		07.03.2024	
A	Updated following consultation comments	JPG	JL	19.01.2024	
REV	DESCRIPTION	DRN	CHD	DATE	
<input type="checkbox"/>	PRELIMINARY	<input type="checkbox"/>	INFORMATION	<input type="checkbox"/>	TENDER
<input type="checkbox"/>	CONSTRUCTION	<input type="checkbox"/>	AS BUILT		

SCALE 1:500 @ A1 DATE JULY 2023

DRAWN JPG CHK

DRAWING NO. 18924/1004 REV B

TITLE LONDON ROAD
BUNTINGFORD

DETAILS FIRE VEHICLE STRATEGY

 **Woods Hardwick**
Architecture | Engineering | Planning | Surveying

BEDFORD : HEAD OFFICE
15-17 Goldington Road
Bedford MK40 3NH
T: +44 (0) 1234 268862

BIRMINGHAM
Fort Dunlop, Fort Parkway
Birmingham B24 9FE
T: +44 (0) 121 6297784

ONLINE: mail@woodshardwick.com | woodshardwick.com

PLEASE CONSIDER THE ENVIRONMENT BEFORE PRINTING THIS DRAWING

